

A PROJECT BY



HARSHAL HANMANTE

Builders & Developers Pvt. Ltd.

Ethical Practice



WITH 5 YEARS
OF WARRANTY



Virat Plaza

Basement Floor

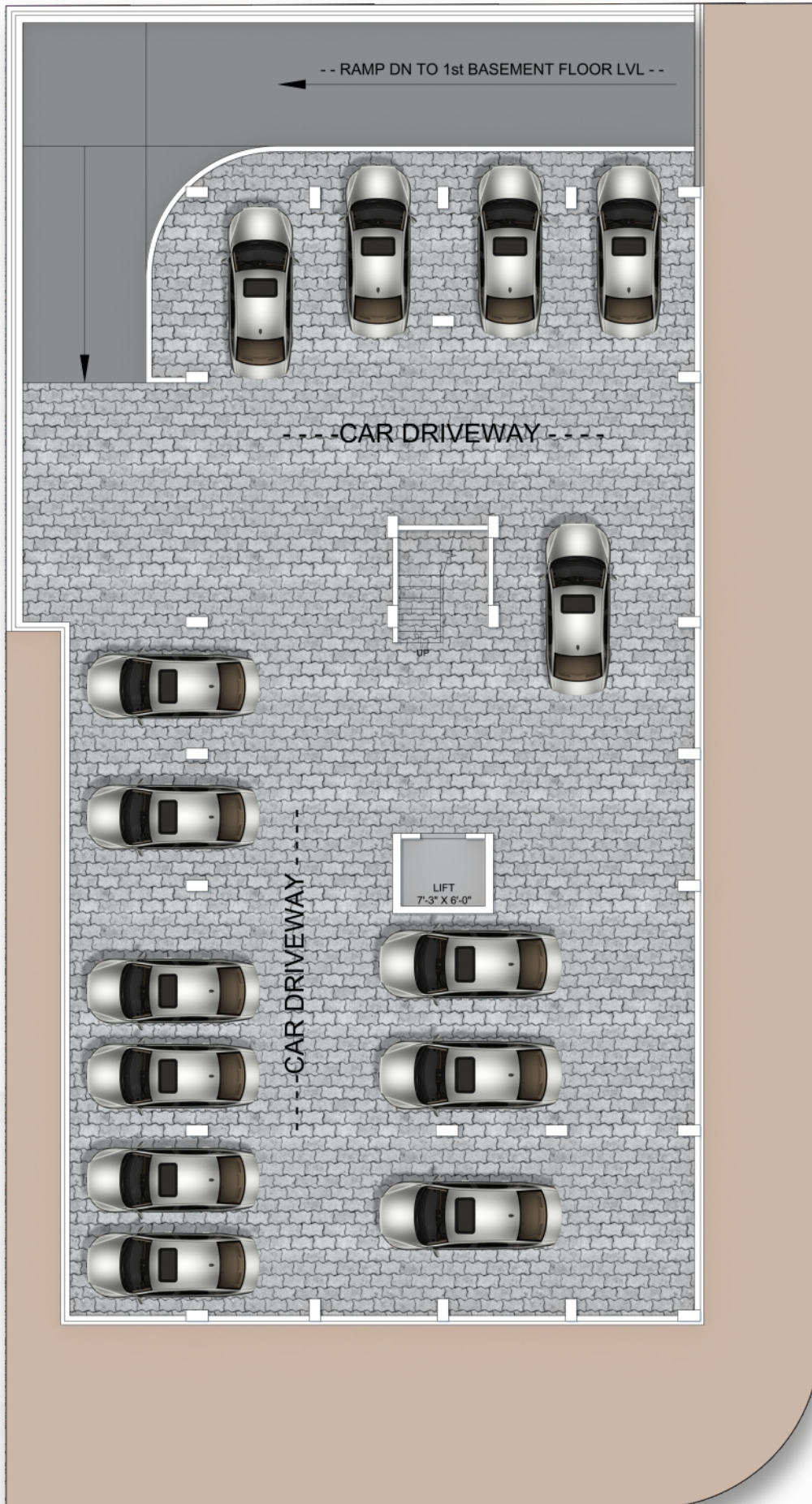

Ground Floor



First Floor



Second To Seventh Floor

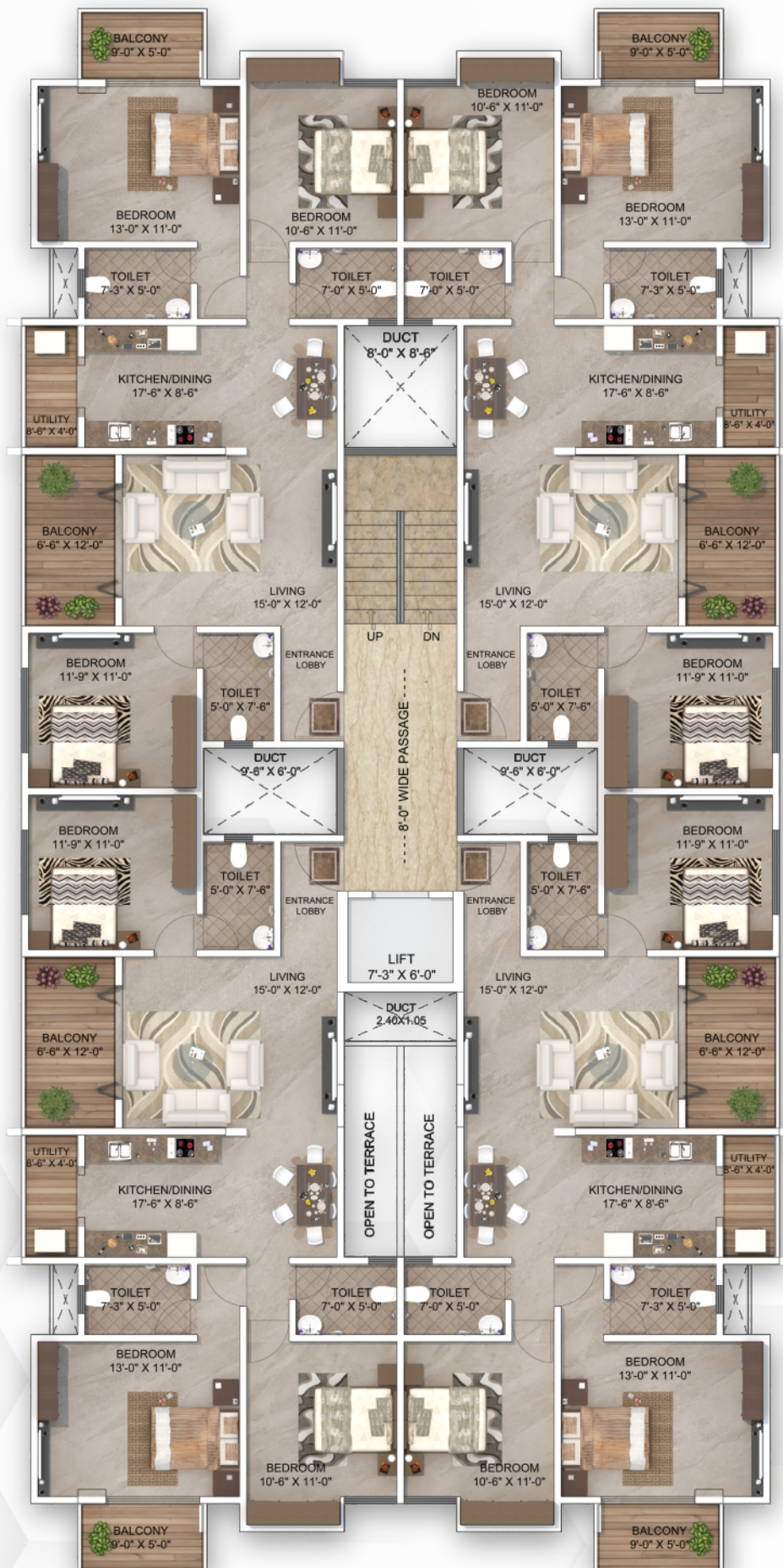

Entrance Lobby View



Cut Section View



Amenities

LIVING

- Gypsum work on wall.
- 2x4 branded vitrified tiles in all rooms.
- False ceiling in living area with lights.

KITCHEN

- Granite kitchen platform with stainless steel sink and ceiling touch glazed tiles with digital print.

DOOR

- Video door phone
- Doors will be designer laminated and branded (Europa/Godrej) fitting.
- Main door frames are plywood and toilet door frames are granite .
- Bedroom and balcony are of good quality ply wood frame

WINDOW

- Window frame will be of granite powder coated aluminum sliding 3 track windows.

ELECTRIC WORK

- Concealed electrification with polycap wiring and branded switches with adequate light points.
- TV cable points in living room and bedroom.
- Jaguar led tube lights in all rooms.

PLUMBING

- Concealed plumbing fitting in finolex pipe.
- Overheads underground water tank with plumbing arrangement.
- Electrical & plumbing point for water and washing machine.

BATHROOM

- In all bathroom glaze tiles upto ceiling with digital print.
- Indian type WC in common bath and western type in attached bath with flushing system.
- Hot and cold water mixer valve in all bath with jaquar essco fitting.
- Instant water heater gizer in bathroom.

WATER PROOFING

- Water proofing treatment in terrace, toilets and building roof in brick bat coba.

PAINTING

- Exterior: Maintenance free acrylic paint.
- Interior: Pleasant shades in emulsion paint.

PARKING

- Allotted parking for each flat.



External Amenities

- RCC Earthquake resistance Construction
- Red Bricks Work
- Vastu Based Design

- Lift with Battery Backup
- External Walls 6 inches
- Internal Walls 4 Inches thick Brick Works
- Gypsum Wall Finish for hall

Special Amenities

- CCTV Cameras
- Solar Panel (All Building Maintenance)
- Open Yoga Meditation at terrace
- Children play area

- Walking track at terrace
- Gazebo sitting
- Decorated lobby
- Wifi ready

- Fire extinguisher in common areas

Location Map

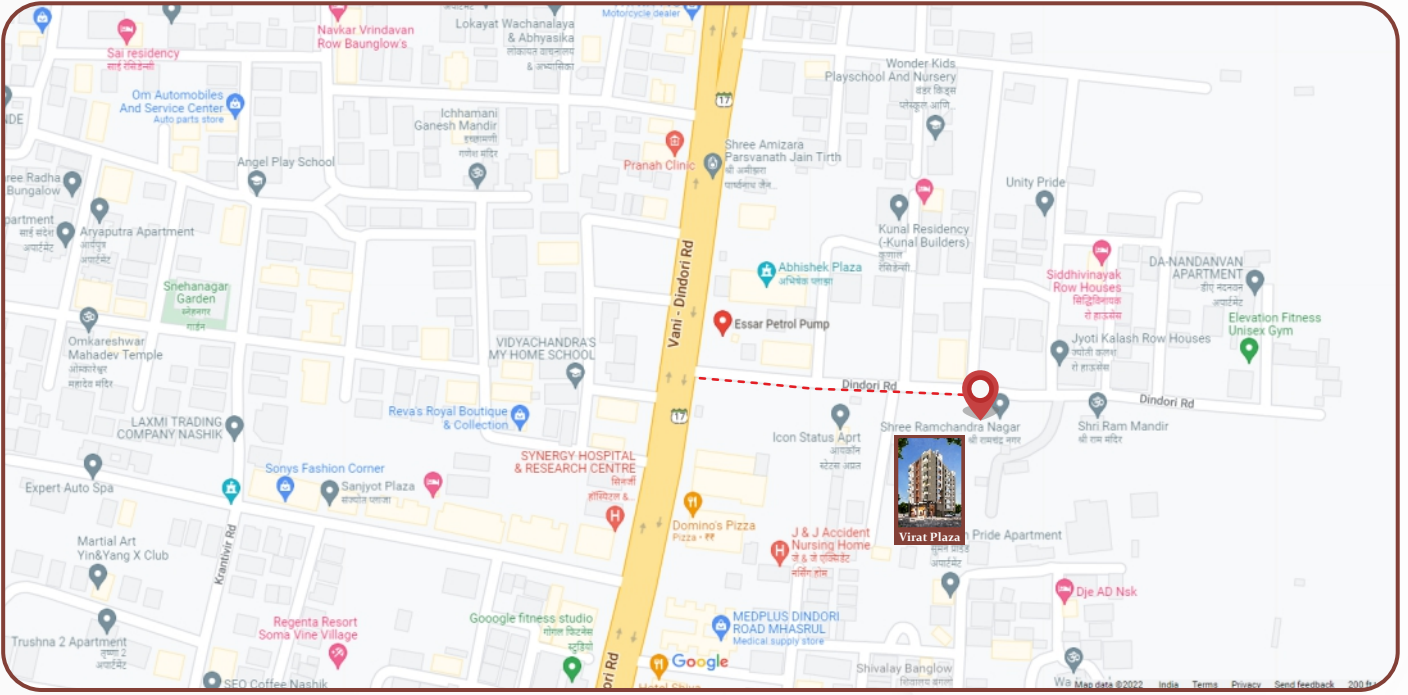

Project By



HARSHAL HANMANTE

Builders & Developers Pvt. Ltd.

Ethical Practice

SITE ADDRESS

plot no. 16 & 17, Behind Essar Petrol Pump, Dindori Road, Nashik-422004.

OFFICE ADDRESS

1, Yadnesh Apartment, Near Savarkar Garden,
Opp. Akash Petroleum, Dindori Road, Nashik 422 004.

FOR BOOKING CONTACT

+91 9225 3454 95, +91 9860 0098 60

Architect

Ar. Kishor Shinde

Legal Advisor

Adv. Gulab Aher

RCC Consultant

Yogin Kulkarni

Associated With



Project Approved By

